



上海惠而顺精工科技发展有限公司

Shanghai WILSON Precision Technology Co., Ltd.

技工室专用切削工具

Dental Laboratory Instruments

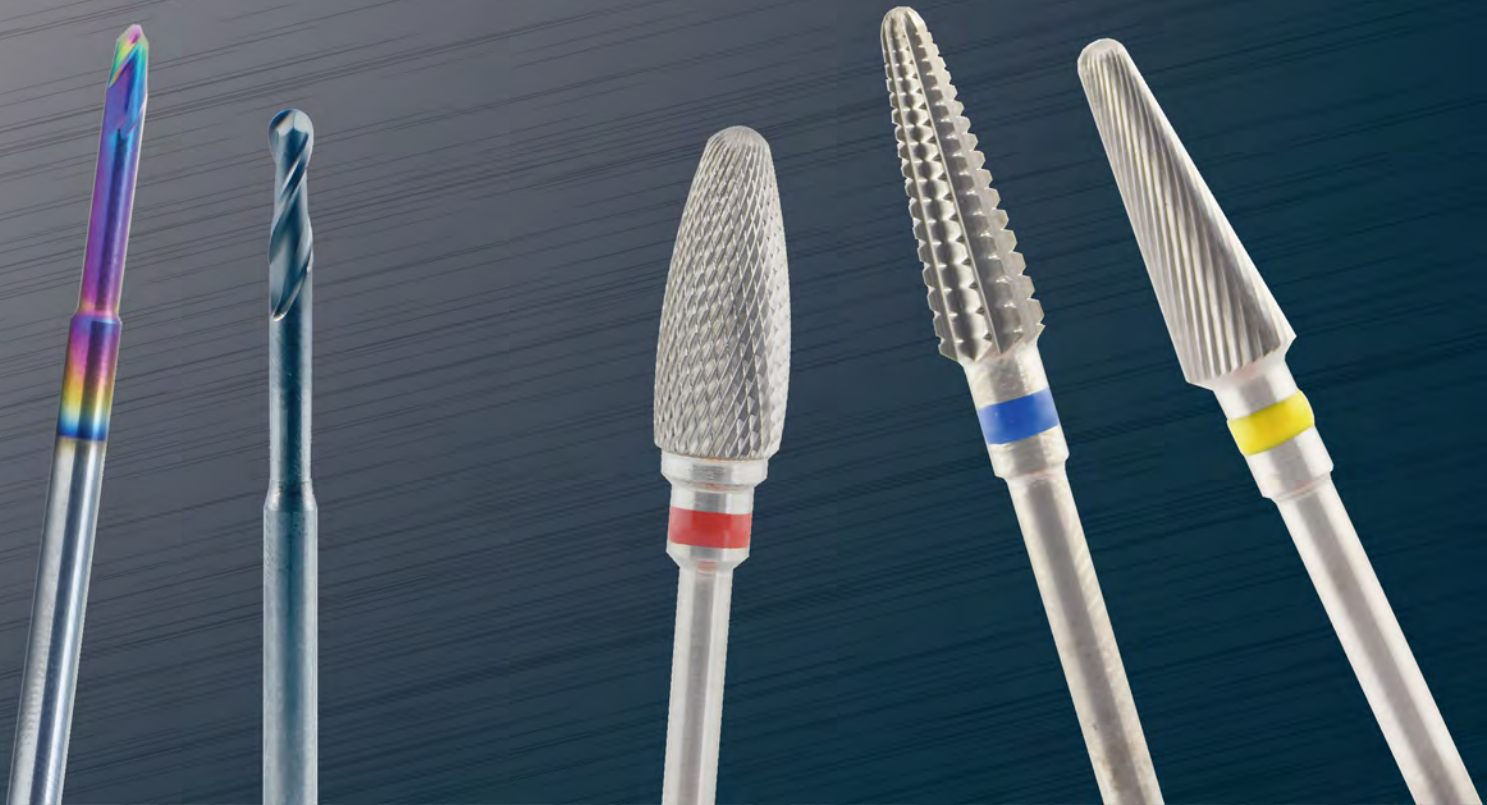



上海惠而顺精工科技发展有限公司
Shanghai WILSON Precision Technology Co., Ltd.

© 2017.01

公司简介 Company Profile

上海惠而顺精工科技发展有限公司是一家专业硬质合金切削工具制造商，拥有多年刀具生产经验。公司的牙科产品选用世界著名品牌材料，使用五轴五联动数控工具磨床精密加工，并通过 ISO 9001-2008 国际标准质量体系认证确保产品的品质。

公司的牙科磨头、研磨车针和种钉机钻等牙科刀具已被众多义齿工厂选用。氧化锆专用铣刀可以匹配所有主流 CAD/CAM 机加工系统。进口的 CVD 金刚石涂层技术，提高了加工精度和使用寿命，也使产品的性价比领先世界水平！

Shanghai WILSON Precision Technology Co., Ltd. is an ISO 9001-2008 certified company, professional in manufacturing various kinds of carbide cutting tools. By choosing high - quality tungsten carbide materials, processing them with 5 - axis CNC grinding machines, coating them with cutting - edge technology and testing them through a sound QA system, WILSON ensures the good quality of its products.

WILSON's dental laboratory tools have been favored by numerous labs around the world. Moreover, its CAD/CAM end-mills, coated with CVD diamond coating technology, enjoy an extra-long service life. It is these cost-effective products and good after-sales services that have earned WILSON a good reputation in the global market.

For more information, please visit: www.wilsonprecisiontool.com
www.wilsonshopping.com



现代化管理车间
Modern Manufacturing



高精度检测仪
High Accuracy Measuring



进口CVD金刚石涂层设备
CVD Diamond Coating Equipment





版权所有。

复制产品，包括提取和复制照片都需要获得上海惠而顺精工科技发展有限公司的书面授权。

所有提供的服务、订单和交货都必须遵守惠而顺的“基本销售和交付条款”。

我们保留修改产品使用范围和产品设计权利，同样也包括产品的插图及数据的修正。

All rights reserved.

Reproduction, also by extract and reproducing photos are only permitted with written authorization of Shanghai WILSON Precision Technology Co., Ltd.

All offers, orders and deliveries are subject to WILSON's "General Sales and Delivery Terms".

We reserve the right to modify our range of products and their design as well as to deviate from the illustrations and data shown.

术语与定义

Terms and Definitions

齿形及齿密度
Shape and Type of Tooth

产品图片
Product Picture

ISO 110
 交叉齿超细密度
 Cross cut super fine

使用及标识
Application Symbols



ISO编码
ISO Codification

刃长 L mm	[8.0]	--
刃径 D mm	[2.3]	--
编号 Order No.	5000101	
[ISO No. 500 104 -	141 110 023]	

刃部长度
Flute Length

ISO编码
ISO Codification

刃部直径
Flute Diameter

使用及标识 Application Symbols



研磨技术
Laboratory milling technique



模型铸造技术
Model casting technique



牙冠及齿桥技术
Crown and bridge technique



模型制作
Model production



表面丙烯酸树脂和烤瓷
Acrylic and porcelain veneer



丙烯酸树脂技术
Acrylic technique

*此类标识仅提供使用建议。The symbols are for reference only.

ISO编码 ISO Codification

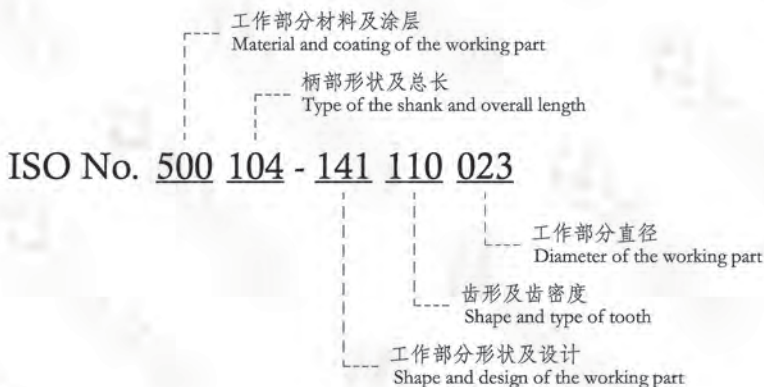

*此ISO编码是基于ISO 6360-1/2/3/4: 2004 牙科旋转器械的编码系统所制定的。

The specific ISO codification is based on ISO 6360 -1/2/3/4: 2004 dentistry number coding system for rotary instruments.

使用说明

Instruction of Use

1. 确认产品包装完整性。
Ensure that the package of the product is intact.
2. 使用前请仔细检查产品，任何损坏或变形都会导致产品断裂。
Examine the product before use. Any damage or deformation may cause the breakage of the products.
3. 请佩戴护目镜。
Safety glasses are recommended.
4. 确保产品被固定于筒夹或手柄中。
Make sure that the product is inserted all the way into the handpiece and securely fastened.

为达到最佳使用效果：

For the best result:

1. 在产生任何接触之前，产品必须在推荐的速度下旋转。
Product must be rotated at recommended speed before any contact is made.
2. 无须施加很大的压力。
Apply low contact pressure and brush stroke.
3. 避免横向压力。
Avoid using the products with a heavy transverse cutting pressure.

安全须知

Safety Rules

1. 确保产品被稳定地安装在手柄或筒夹中。
Ensure that the product is securely gripped in the handpiece or the collet.
2. 请不要使用已经产生磨损的产品。
Do not use worn-out products.
3. 请不要施加过大的压力。
Do not apply excessive pressure on the products.
4. 避免接触产品的尖锐部位。
Avoid to touch the sharp part of the products.

齿科钨钢打磨头 Tungsten Carbide Dental Lab Burs	6

交叉齿 - Cross Cut	
超细密度 细密度 标准密度 粗密度 超粗密度 Super Fine Fine Standard Coarse Super Coarse	7 - 9

右旋齿 - Plain Cut	
超细密度 细密度 标准密度 粗密度 超粗密度 Super Fine Fine Standard Coarse Super Coarse	9 - 10

直刃齿 - Straight Edge	
螺旋齿 交叉齿 Spiral Cut Cross Cut	11

钻石齿 - Diamond Cut	
细密度 标准密度 Rough Surface Prism Surface	11

螺旋齿 - Spiral Cut	
超细密度 细密度 Super Fine Fine	12

钨钢种钉机钻头 Tungsten Carbide Pindex Drills	12

钨钢研磨车针 Tungsten Carbide Milling Instrument	13 - 14

齿科氧化锆磨头 Zirconia Ceramic Dental Lab Burs	15 - 18

立铣刀 - 氧化锆义齿专用 CAD/CAM End Mills - for Zirconia	19

3M ESPE Lava Amann Girrbach ARUM Dentium	20

Imes-Icore Roland Sirona VHF Zirkon Zahn	21 - 22

Wieland Yena	23

立铣刀 - 金属义齿专用 CAD/CAM End Mills - for Metal	24

Amann Girrbach ARUM Imes-Icore	24

附录 I - 推荐转速表 Index I - Speed Recommendation	25

附录 II- 产品索引 Index II - Reference Form	26

齿科钨钢打磨头

Tungsten Carbide Dental Lab Burs

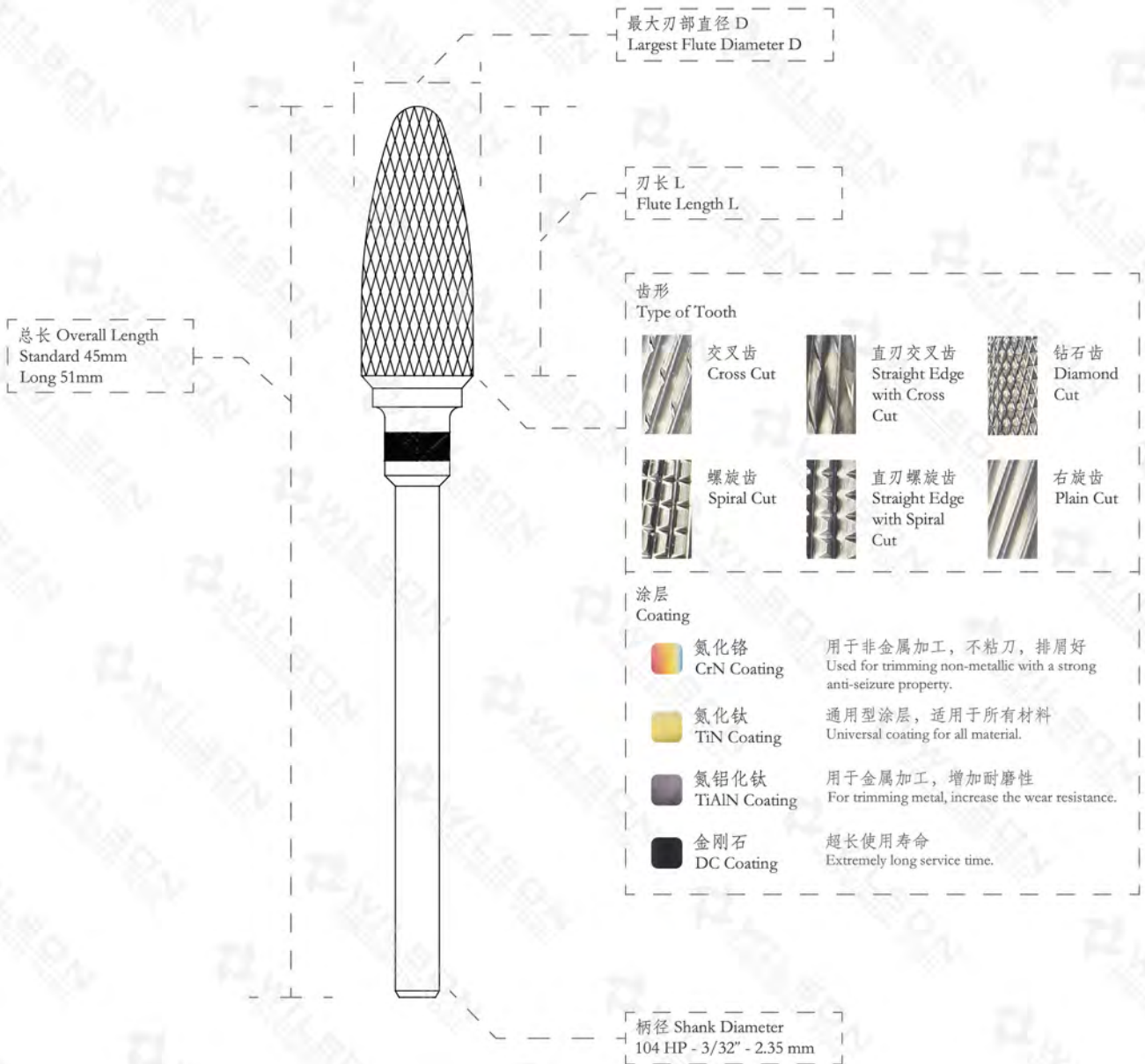

打磨金属支架
For Trimming Metal



打磨支架缝隙
For Trimming Metal



打磨树脂及石膏
For Trimming Acrylic and Plaster



石膏修边
For Contouring

齿科钨钢打磨头 - 交叉齿

Tungsten Carbide Dental Lab Burs - Cross Cut

ISO 110

交叉齿超细密度
Cross cut super fine



刃长 L mm	8.0	16.0	17.0	8.0	8.0	13.0	14.5	14.0	14.0	5.5
刃径 D mm	2.3	2.3	2.3	1.6	2.3	4.5	2.3	4.0	4.5	2.3
编号 Order No.	5000101	5000102	5000103	5000104	5000105	5000106	5000107	5000108	5000109	5000110
ISO No. 500 104 -	141 110 023	145 110 023	180 110 023	198 110 016	198 110 023	200 110 045	201 110 023	201 110 040	201 110 045	227 110 023



刃长 L mm	5.4	5.0	5.0	7.0	11.5	4.0	8.0	16.0
刃径 D mm	2.3	2.3	2.9	2.3	4.0	2.3	2.3	2.3
编号 Order No.	5000112	5000113	5000114	5000115	5000117	5000118	5000119	5000120
ISO No. 500 104 -	239 110 023	237 110 023	237 110 029	257 110 023	274 110 040	277 110 023	289 110 023	292 110 023

ISO 140

交叉齿细密度
Cross cut fine



刃长 L mm	2.0	16.0	8.0	12.5	16.0	17.0	8.0	8.0	11.5	13.0
刃径 D mm	2.3	2.3	2.3	6.0	2.3	2.3	1.6	2.3	3.1	4.5
编号 Order No.	5000201	5000202	5000203	5000204	5000205	5000206	5000207	5000208	5000209	5000210
ISO No. 500 104 -	001 140 023	116 140 023	141 140 023	143 140 060	145 140 023	180 140 023	198 140 016	198 140 023	199 140 031	200 140 045



刃长 L mm	14.5	14.0	15.0	5.5	5.0	5.0	12.0	11.0	9.0	12.0
刃径 D mm	2.3	4.0	6.0	2.3	2.3	2.9	6.0	6.0	4.0	6.0
编号 Order No.	5000211	5000212	5000213	5000214	5000216	5000217	5000218	5000219	5000221	5000222
ISO No. 500 104 -	201 140 023	201 140 040	201 140 060	227 140 023	237 140 023	237 140 029	237 140 060	239 140 060	257 140 040	257 140 060



刃长 L mm	8.0	12.0	14.5	14.5	4.0	9.5	8.0	16.0
刃径 D mm	4.0	6.0	6.0	6.0	2.3	6.0	2.3	2.3
编号 Order No.	5000223	5000224	5000226	5000227	5000229	5000230	5000233	5000234
ISO No. 500 104 -	263 140 040	263 140 060	272 140 060	275 140 060	277 140 023	277 140 060	289 140 023	292 140 023

齿科钨钢打磨头 - 交叉齿

Tungsten Carbide Dental Lab Burs - Cross Cut

ISO 190

交叉齿标准密度
Cross cut standard



刃长 L mm	0.8	1.0	1.2	1.4	1.6	2.0	2.3	2.4	2.8	3.3
刃径 D mm	1.0	1.2	1.4	1.6	1.8	2.3	2.5	2.7	3.0	3.5
编号 Order No.	5000301	5000302	5000303	5000304	5000305	5000306	5000307	5000308	5000310	5000312
ISO No. 500 104 -	001 190 010	001 190 012	001 190 014	001 190 016	001 190 018	001 190 023	001 190 025	001 190 027	001 190 030	001 190 035



刃长 L mm	3.5	4.5	5.5	7.0	12.5	16.0	8.0	12.5	16.0	17.0
刃径 D mm	4.0	5.0	6.0	8.0	6.0	2.3	2.3	6.0	2.3	2.3
编号 Order No.	5000313	5000314	5000315	5000316	5000317	5000318	5000319	5000320	5000321	5000322
ISO No. 500 104 -	001 190 040	001 190 050	001 190 060	001 190 080	113 190 060	116 190 023	141 190 023	143 190 060	145 190 023	180 190 023



刃长 L mm	8.0	8.0	11.5	13.0	14.5	14.0	15.0	4.0	5.5	5.4
刃径 D mm	1.6	2.3	3.1	4.5	2.3	4.0	6.0	1.6	2.3	2.3
编号 Order No.	5000326	5000327	5000328	5000329	5000330	5000331	5000332	5000333	5000334	5000335
ISO No. 500 104 -	198 190 016	198 190 023	199 190 031	200 190 045	201 190 023	201 190 040	201 190 060	225 190 016	225 190 023	239 190 023



刃长 L mm	5.0	5.0	12.0	11.0	7.0	9.0	12.0	14.0	8.0	12.0
刃径 D mm	2.3	2.9	6.0	6.0	2.3	4.0	6.0	6.0	4.0	6.0
编号 Order No.	5000336	5000337	5000338	5000339	5000341	5000342	5000343	5000344	5000345	5000346
ISO No. 500 104 -	237 190 023	237 190 029	237 190 060	239 190 060	257 190 023	257 190 040	257 190 060	213 190 060	263 190 040	263 190 060



刃长 L mm	11.5	14.5	14.5	4.0	9.5	8.0	16.0
刃径 D mm	4.0	6.0	6.0	2.3	6.0	2.3	2.3
编号 Order No.	5000348	5000349	5000350	5000352	5000353	5000354	5000355
ISO No. 500 104 -	274 190 040	272 190 060	275 190 060	277 190 023	277 190 060	289 190 023	292 190 023

齿科钨钢打磨头 - 交叉齿

Tungsten Carbide Dental Lab Burs - Cross Cut

ISO 220

交叉齿粗密度
Cross cut coarse



刃长 L mm	12.5	13.0	15.0	12.0	11.0	12.0	12.0	14.0	14.5
刃径 D mm	6.0	4.5	6.0	6.0	6.0	6.0	6.0	7.0	6.0
编号 Order No.	5000401	5000402	5000403	5000404	5000405	5000406	5000407	5000408	5000409
ISO No. 500 104 -	143 220 060	200 220 045	201 220 060	237 220 060	239 220 060	257 220 060	263 220 060	263 220 070	272 220 060

ISO 223

交叉齿超粗密度
Cross cut super coarse



刃长 L mm	12.5	14.0	14.5
刃径 D mm	6.0	7.0	6.0
编号 Order No.	5000601	5000602	5000603
ISO No. 500 104 -	143 223 060	263 223 070	272 223 060



齿科钨钢打磨头 - 右旋齿

Tungsten Carbide Dental Lab Burs - Plain Cut

ISO 102

右旋齿超细密度
Plain cut super fine



刃长 L mm	16.0	14.5	14.0	16.0
刃径 D mm	2.3	2.3	4.5	2.3
编号 Order No.	5000701	5000705	5000706	5000708
ISO No. 500 104 -	145 102 023	201 102 023	201 102 045	292 102 023

ISO 133

右旋齿细密度
Plain cut fine



刃长 L mm	16.0	16.0	4.0	14.5	14.0	5.0	8.0	16.0
刃径 D mm	2.3	2.3	0.9	2.3	4.0	2.3	1.2	2.3
编号 Order No.	5000801	5000802	5000803	5000804	5000805	5000806	5000807	5000808
ISO No. 500 104 -	116 133 023	145 133 023	196 133 009	201 133 023	201 133 040	237 133 023	289 133 012	292 133 023

齿科钨钢打磨头 - 右旋齿形

Tungsten Carbide Dental Lab Burs - Plain Cut

ISO 175

右旋齿标准密度
Plain cut standard



刃长 L mm	2.4	2.8	3.0	4.3	5.3	12.5	12.5	11.5	13.0	14.0
刃径 D mm	2.7	3.1	4.0	5.0	6.0	6.0	6.0	3.1	4.5	4.0
编号 Order No.	5000901	5000902	5000903	5000904	5000905	5000906	5000907	5000911	5000912	5000913
ISO No. 500 104 -	001 175 027	001 175 031	001 175 040	001 175 050	001 175 060	113 175 060	143 175 060	199 175 031	200 175 045	201 175 040



刃长 L mm	15.0	14.0	12.0	11.0	12.0	12.0	11.5	14.5	14.5	9.5
刃径 D mm	6.0	6.0	6.0	6.0	6.0	6.0	4.0	6.0	6.0	6.0
编号 Order No.	5000914	5000915	5000916	5000917	5000918	5000919	5000920	5000921	5000922	5000923
ISO No. 500 104 -	201 175 060	213 175 060	237 175 060	239 175 060	257 175 060	263 175 060	274 175 040	272 175 060	275 175 060	277 175 060

ISO 215

右旋齿粗密度
Plain cut coarse



刃长 L mm	12.5	13.0	15.0	12.0	12.0	12.0	14.5
刃径 D mm	6.0	4.5	6.0	6.0	6.0	6.0	6.0
编号 Order No.	5001001	5001002	5001003	5001004	5001005	5001006	5001007
ISO No. 500 104 -	143 215 060	200 215 045	201 215 060	237 215 060	257 215 060	263 215 060	272 215 060

ISO 222

右旋齿超粗密度
Plain cut super coarse



刃长 L mm	12.5	14.0	14.5
刃径 D mm	6.0	7.0	6.0
编号 Order No.	5001101	5001102	5001103
ISO No. 500 104 -	143 222 060	263 222 070	272 222 060

齿科钨钢打磨头 - 直刃齿

Tungsten Carbide Dental Lab Burs - Straight Edge

ISO 176

直刃螺旋齿
Straight Edge
with Sprial Cut



刃长 L mm	14.0	14.0	9.0	12.0	14.0	14.0
刃径 D mm	2.3	4.5	4.0	6.0	7.0	6.0
编号 Order No.	5001201	5001202	5001203	5001204	5001205	5001206
ISO No. 500 104 -	201 176 023	201 176 045	237 176 040	263 176 060	263 176 070	275 176 060

ISO 194

直刃交叉齿
Straight Edge
with Cross Cut



刃长 L mm	8.0	8.0	8.0	13.0	8.0
刃径 D mm	2.3	1.6	2.3	4.0	2.3
编号 Order No.	5001501	5001502	5001503	5001504	5001505
ISO No. 500 104 -	141 194 023	198 194 016	198 194 023	200 194 040	289 194 023

齿科钨钢打磨头 - 钻石齿

Tungsten Carbide Dental Lab Burs - Diamond Cut

ISO 141

钻石齿细密度
Diamond cut
for slightly
rough surface



刃长 L mm	8.0	16.0	14.0	8.0	16.0
刃径 D mm	2.3	2.3	4.5	2.3	2.3
编号 Order No.	5001601	5001602	5001603	5001604	5001605
ISO No. 500 104 -	141 141 023	145 141 023	201 141 045	289 141 023	292 141 023

ISO 191

钻石齿标准密度
Diamond cut
with prism surface



刃长 L mm	16.0	14.0	14.0	8.0	16.0
刃径 D mm	2.3	2.3	4.5	2.3	2.3
编号 Order No.	5001701	5001704	5001705	5001706	5001707
ISO No. 500 104 -	145 191 023	201 191 023	201 191 045	289 191 023	292 191 023

齿科钨钢打磨头 - 螺旋齿形 Tungsten Carbide Dental Lab Burs - Spiral Cut

ISO 137

螺旋齿超细密度
Spiral cut super fine



刃长 L mm	8.0	8.0	8.0	13.5	14.0	8.0
刃径 D mm	2.3	1.6	2.3	4.0	6.0	2.3
编号 Order No.	5001301	5001303	5001304	5001305	5001307	5001308
ISO No. 500 104 -	141 137 023	198 137 016	198 137 023	200 137 040	275 137 060	289 137 023

ISO 134

螺旋齿细密度
Spiral cut fine



刃长 L mm	13.5	9.5	14.0	14.0	10.5	5.5	5.0	11.5	14.0	10.5
刃径 D mm	2.3	2.3	4.0	2.3	2.3	2.3	2.3	4.0	6.0	2.3
编号 Order No.	5001401	5001402	5001406	5001407	5001408	5001409	5001410	5001411	5001412	5001413
ISO No. 500 104 -	143 134 023	185 134 023	196 134 040	201 134 023	199 134 023	237 134 023	237 134 023	274 134 040	275 134 060	290 134 023

钨钢种钉机钻头 Tungsten Carbide Pindex Drills

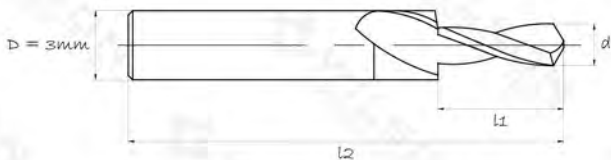

我司的种钉机钻头选用优质钨钢材料制成，经久耐用。
欢迎来图来样加工。

Our pindex drills are made from high quality tungsten carbide material which guarantees a long service life.

Customization services are offered upon request.



刃径 d mm	1.95	2.0	1.85	1.75	1.6	1.55	2.22
编号 Order No.	5600008	5600009	5600012	5600013	5600014	5600015	5600020

钨钢研磨车针

Tungsten Carbide Milling Instrument

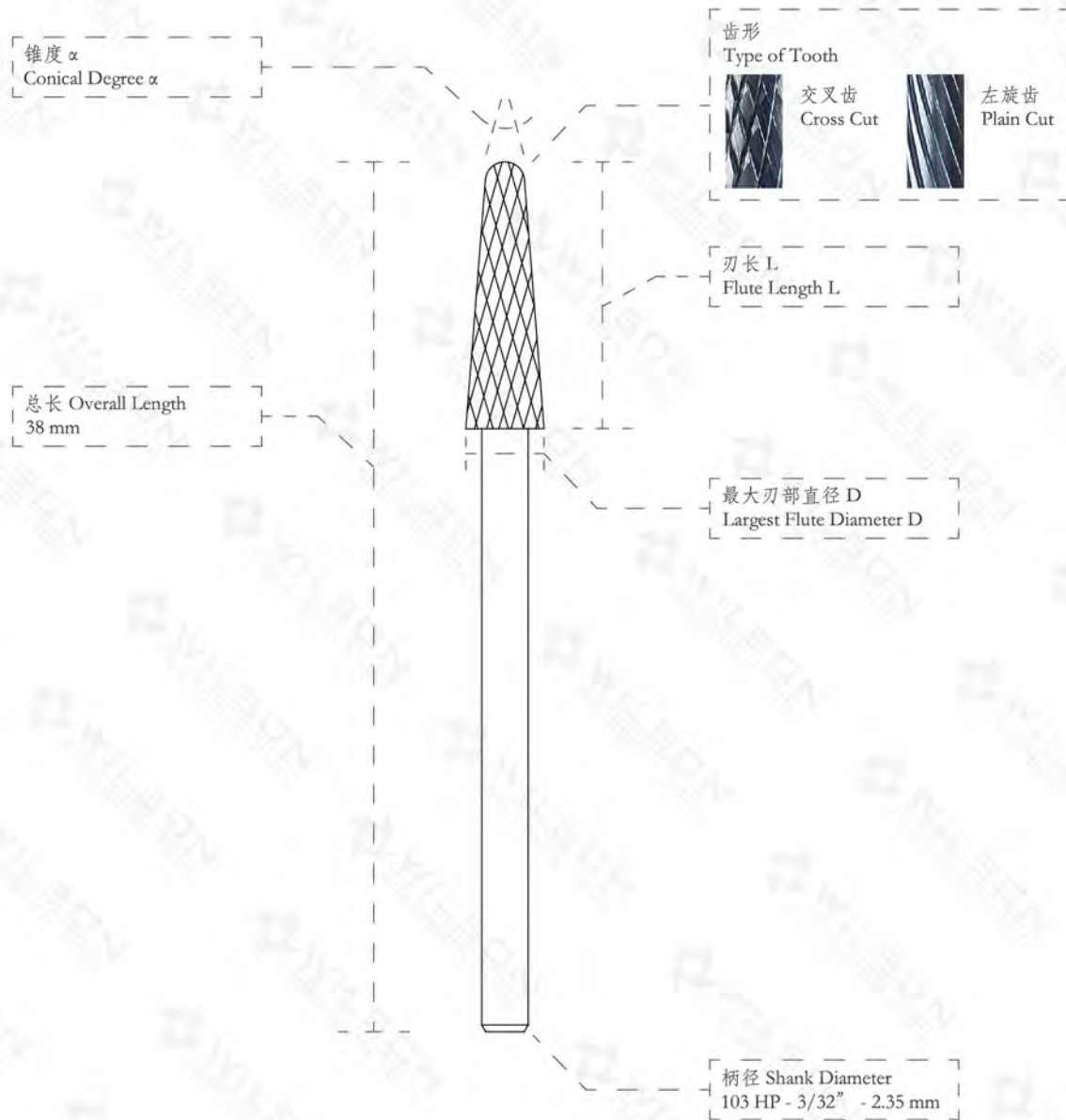

我司的研磨车针选用优质的钨钢按照 ISO 标准制成，保证产品尺寸精准。其更加优化的齿形设计保证了超长的使用寿命，主要用于精修种植肩台，并在贵金属、金属和钛上均能保持良好的切削性能。

Made from high quality tungsten carbide, our milling burs are guaranteed with precise tolerance in conformity with ISO standards. Its optimally coordinated geometry of the cutting blades promises an extra-long service life and high cutting capacity on various materials, including precious & non - precious metals and titanium. The main application is to trim the shoulder of the tooth implant.

钨钢研磨车针

Tungsten Carbide Milling Instrument

ISO 135

右旋齿细密度
Plain cut fine



刃长 L mm	8.0	10.0	15.0	13.0	13.0	13.0
刃径 D mm	1.0	1.5	2.3	2.3	3.1	4.0
编号 Order No.	5403101	5403102	5403103	5403104	5403105	5403106
ISO No. 500 103 -	137 135 010	137 135 015	137 135 023	194 135 023	194 135 031	194 135 040

ISO 190

交叉齿标准密度
Cross cut standard



刃长 L mm	8.0	10.0	15.0	13.0	13.0	13.0
刃径 D mm	1.0	1.5	2.3	2.3	3.1	4.0
编号 Order No.	5401101	5401102	5401103	5401104	5401105	5401106
ISO No. 500 103 -	137 190 010	137 190 015	137 190 023	194 190 023	194 190 031	194 190 040

ISO 220

交叉齿粗密度
Cross cut coarse



刃长 L mm	8.0	10.0	15.0	13.0	13.0	13.0
刃径 D mm	1.0	1.5	2.3	2.3	3.1	4.0
编号 Order No.	5402101	5402102	5402103	5402104	5402105	5402106
ISO No. 500 103 -	137 220 010	137 220 015	137 220 023	194 220 023	194 220 031	194 220 040

ISO 217/366

蜡型车针
Wax Cutter



刃长 L mm	8.0	10.0	15.0	13.0	13.0	13.0
刃径 D mm	1.0	1.5	2.3	2.3	3.1	4.0
编号 Order No.	5404101	5404102	5404103	5404104	5404105	5404106
ISO No. 500 103 -	137 366 010	137 366 015	137 366 023	194 217 023	194 217 031	194 217 040

齿科氧化锆打磨头

Zirconia Ceramic Dental Lab Burs

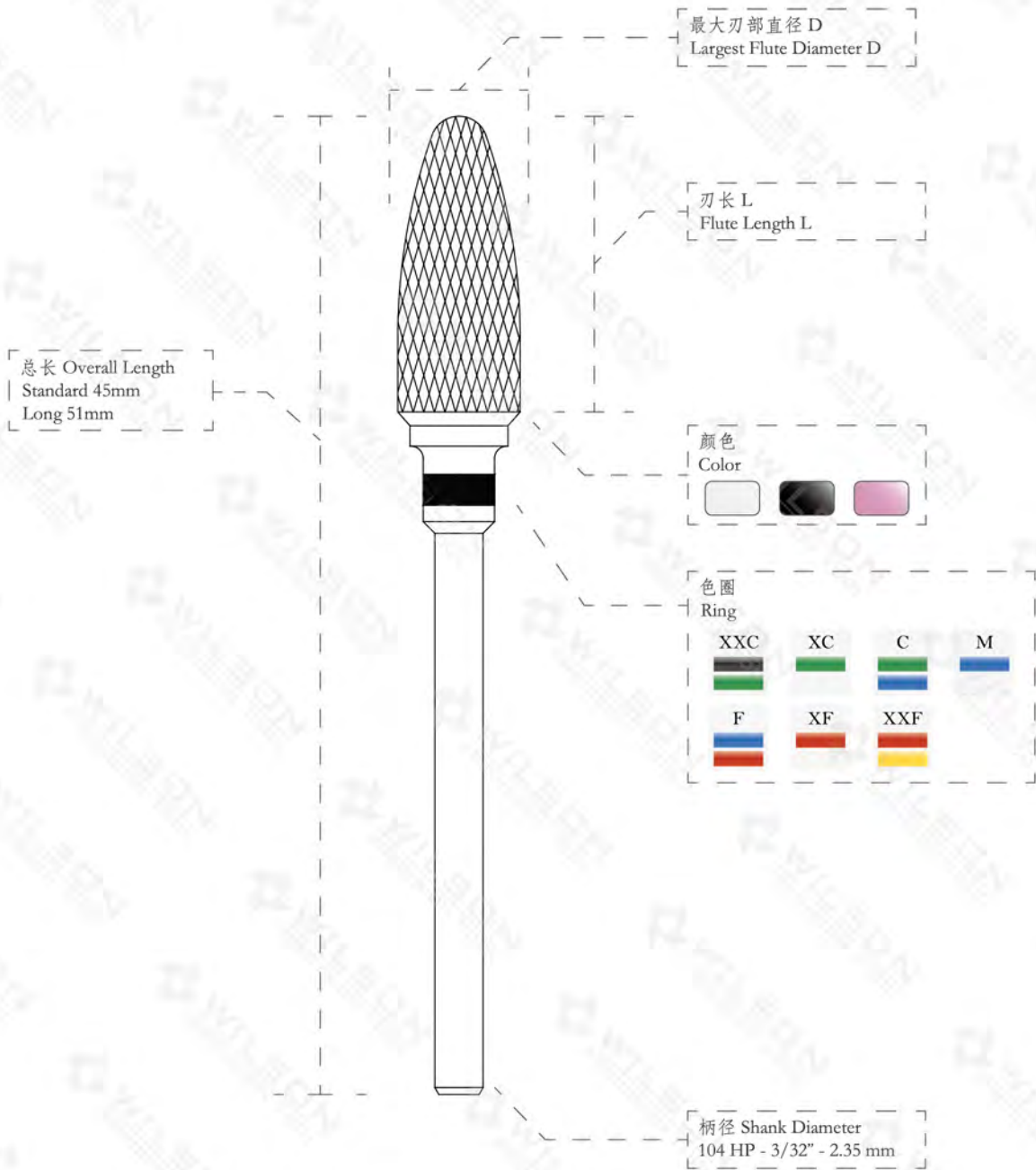

氧化锆陶瓷磨头适用于打磨丙烯酸树脂、石膏等非金属材料。
The zirconia burs are suitable for trimming non-metallic material like acrylic resin, plaster, etc.

- 更轻便 Lighter

降低转动惯量，使打磨更平顺。
Reduce the moment of inertia; make the grinding more smooth and comfortable.

- 耐腐蚀 Corrosion Resistant

能够耐酸碱清洗液的腐蚀。
Resistance to the acid or alkali cleaning fluid.

- 耐热 Heat Resistant

防止温度过高所产生的伤害。
Prevent the overheating damage.

- 更光滑 Smooth Surface

打磨面更光滑，排屑好。
A shinier surface, without clogging.



齿科氧化锆打磨头

Zirconia Ceramic Dental Lab Burs

ISO 272

火炬状 - 交叉齿

Bullet Shape - Cross Cut



刃长 L mm	14.5	14.5	14.5	14.5	14.5	14.5	14.5
刃径 D mm	6.0	6.0	6.0	6.0	6.0	6.0	6.0
编号 Order No.	6400201	6400301	6400401	6400501	6400601	6400701	6400801



刃长 L mm	14.5	14.5	14.5	14.5	14.5	14.5	14.5
刃径 D mm	6.0	6.0	6.0	6.0	6.0	6.0	6.0
编号 Order No.	6410201	6410301	6410401	6410501	6410601	6410701	6410801



刃长 L mm	14.5	14.5	14.5	14.5	14.5	14.5
刃径 D mm	6.0	6.0	6.0	6.0	6.0	6.0
编号 Order No.	6300301	6300401	6300501	6300601	6300701	6300801

ISO 272

火炬状 - 直刃螺旋齿

Bullet Shape - Spiral Cut



刃长 L mm	14.5	14.5	14.5
刃径 D mm	6.0	6.0	6.0
编号 Order No.	6402401	6402501	6402601

ISO 272

火炬状 - 左手齿

Bullet Shape - Left Hand



刃长 L mm	14.5	14.5	14.5
刃径 D mm	6.0	6.0	6.0
编号 Order No.	6405401	6405501	6405601

齿科氧化锆打磨头

Zirconia Ceramic Dental Lab Burs

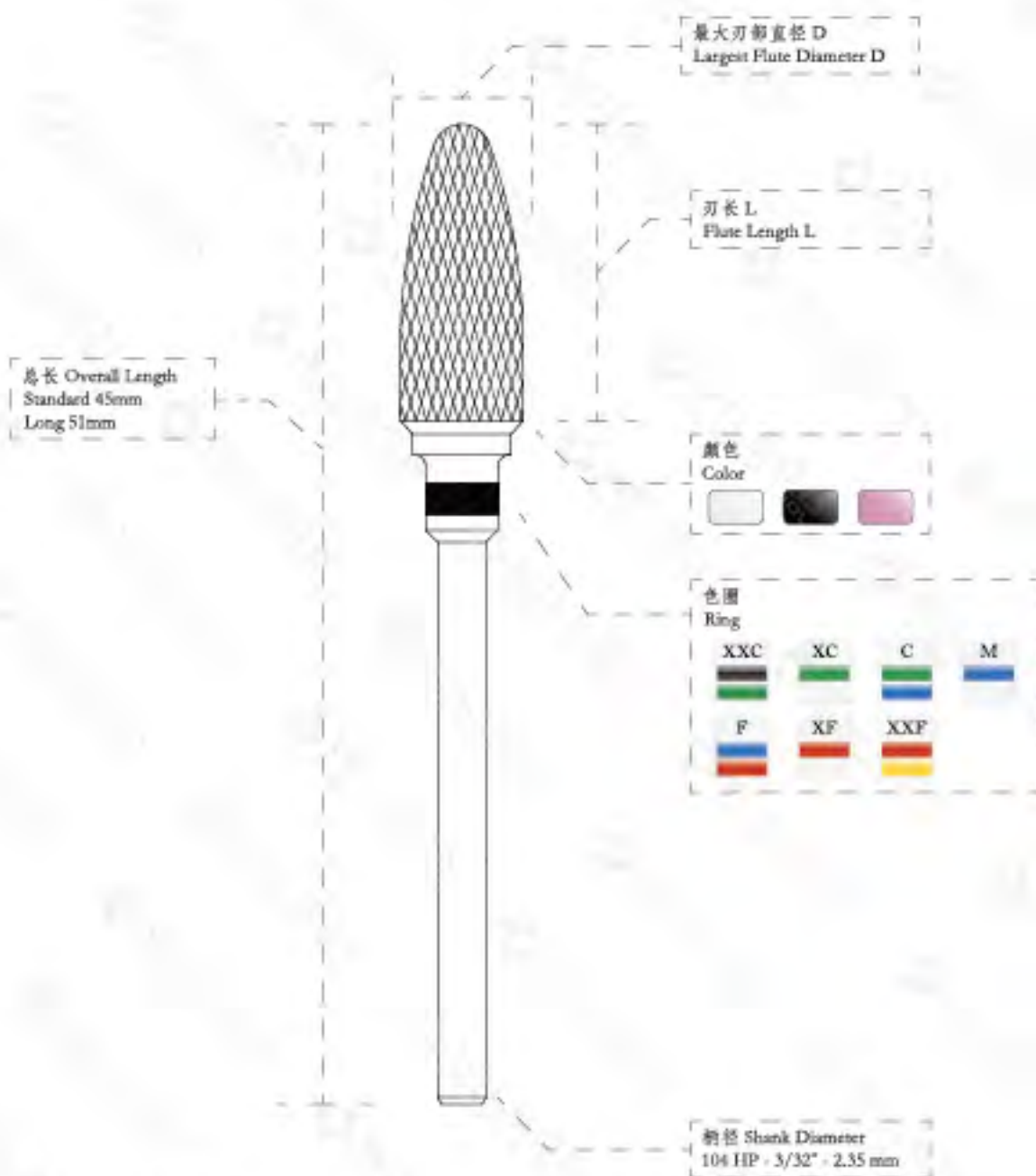

氧化锆陶瓷磨头适用于打磨丙烯酸树脂、石膏等非金属材料。

The zirconia burs are suitable for trimming non-metallic material like acrylic resin, plaster, etc.

- 更轻便 Lighter

降低转动惯量，使打磨更平顺。

Reduce the moment of inertia, make the grinding more smooth and comfortable.

- 耐腐蚀 Corrosion Resistant

能够耐酸碱清洗液的腐蚀。

Resistance to the acid or alkali cleaning fluid.

- 耐热 Heat Resistant

防止温度过高所产生的伤害。

Prevent the overheating damage.

- 更光滑 Smooth Surface

打磨面更光滑，排用好。

A shinier surface, without clogging.



齿科氧化锆打磨头

Zirconia Ceramic Dental Lab Burs

ISO 201

锥形 - 交叉齿

Conical Shape - Cross Cut



刃长 L mm	14.5	14.5	14.5	14.5	14.5	14.5	14.5
刃径 D mm	6.0	6.0	6.0	6.0	6.0	6.0	6.0
编号 Order No.	6400202	6400302	6400402	6400502	6400602	6400702	6400802



刃长 L mm	13.0	13.0	13.0	13.0
刃径 D mm	4.5	4.5	4.5	4.5
编号 Order No.	6400305	6400405	6400505	6400605



刃长 L mm	13.0	13.0	13.0	13.0	13.0	13.0	13.0	17.0	8.0
刃径 D mm	4.0	4.0	4.0	4.0	4.0	4.0	4.0	2.3	1.6
编号 Order No.	6300205	6300305	6300405	6300505	6300605	6300705	6300805	6300207	6300312

ISO 201

锥形 - 直刃螺旋齿

Conical Shape - Spiral Cut



刃长 L mm	13.0	13.0
刃径 D mm	4.5	4.5
编号 Order No.	6402305	6402505

齿科氧化锆打磨头

Zirconia Ceramic Dental Lab Burs

ISO 001

球形-交叉齿

Ball Shape - Cross Cut



刃长 L mm	3.5	4.5	5.3	5.3	5.3
刃径 D mm	4.0	5.0	6.0	6.0	6.0
编号 Order No.	6400517	6400518	6400519	6400619	6400719



刃长 L mm	2.0	2.0	2.0	3.5	4.5	5.3	4.5
刃径 D mm	2.3	3.0	3.0	4.0	5.0	6.0	5.0
编号 Order No.	6300315	6300304	6300504	6300517	6300518	6300519	6310518

ISO 141

直筒球头-交叉齿

Cylindrical - Cross Cut



刃长 L mm	16	8.0
刃径 D mm	2.3	1.2
编号 Order No.	6300206	6300211

ISO 113

直筒端齿-交叉齿

End Cut - Cross Cut



刃长 L mm	12.5	12.5
刃径 D mm	6.0	6.0
编号 Order No.	6400503	6400603

立铣刀 CAD/CAM End Mills

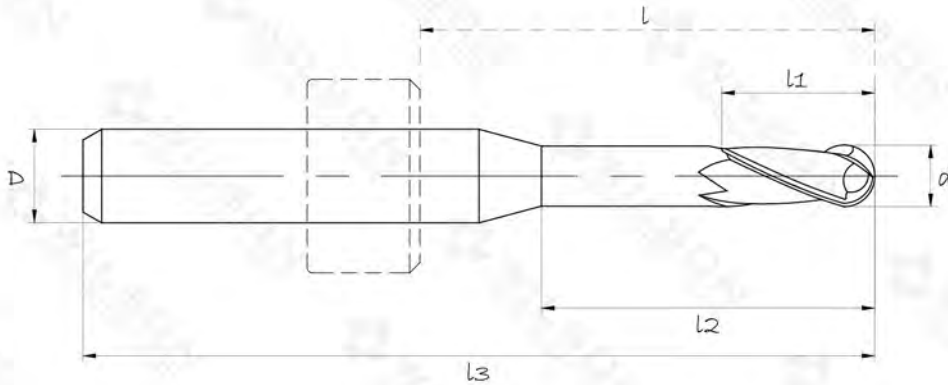

- * D: 柄部直径 Shank Diameter (mm)
- d: 刃部直径 Flute Diameter (mm)
- l1: 刃长 Flute Length (mm)
- l2: 有效长度 Effective Length (mm)
- l3: 总长 Overall Length (mm)
- l: 上环高度 Ring Position (mm)

我司提供硬质合金铣刀适用于大多数CAD/CAM设备或系统，可加工氧化锆、纯钛、钴铬合金和PMMA等义齿材料。

为提高产品的使用寿命，根据不同的被加工材料，我司的CAD/CAM铣刀会使用不同的涂层。

如: 加工氧化锆，推荐使用DLC或DC涂层(可达到8-10倍的使用寿命)；

加工纯钛或钴铬合金，推荐使用TiAlN涂层；

加工PMMA，推荐使用CrN涂层。

欢迎来图来样加工。

Our solid carbide end mills, compatible with mainstream CAD/CAM machines or systems, are good choice for trimming zirconia porcelain, titanium, cobalt-chromium alloy, PMMA and etc.

Depending on the trimmed material, we recommend different coatings.

While DLC and DC coating are for zirconia, TiAlN coating is targeted at metals, and CrN coating is especially suitable for PMMA. The DC coating end mills can reach an 8 to 10 times of the service life.

Customization services are offered upon request.



类金刚石涂层
Diamond-like Carbon (DLC)



金刚石涂层
Diamond Carbon (DC)



氮化铬涂层
Chrome-Nitride (CrN)

立铣刀 - 氧化锆义齿专用
CAD/CAM End Mills - for Zirconia



3M ESPE
Lava

d	l1	l2	l3	D	l	CrN	DLC	DC
						Order No.		
1.0	3.5	16	38	3		5321102	5381102	5391102
2.0	3.5	16	38	3		5321202	5381202	5391202
1.0	2.0	25	50	3		5321109	5381109	5391109
2.0	2.0	25	50	3		5321213	5381213	5391213



Amann
Girrbach

d	l1	l2	l3	D	l	CrN	DLC	DC
						Order No.		
0.6	3.5	13	47	3	20.5	5321006	5381006	5391006
1.0	3.5	16	47	3	20.5	5321104	5381104	5391104
2.5	3.5	16	47	3	20.5	5321206	5381206	5391206



ARUM

d	l1	l2	l3	D	l	CrN	DLC	DC
						Order No.		
1.0	2.0	16	55	6		5324107	5384107	5394107
2.0	6.0	20	55	6		5324208	5384208	5394208



Dentium

d	l1	l2	l3	D	l	CrN	DLC	DC
						Order No.		
1.0	3.5	16	50	6		5324102	5384102	5394102
2.0	3.5	16	50	6		5324202	5384202	5394202

立铣刀 - 氧化锆义齿专用
CAD/CAM End Mills - for Zirconia



Imes-Icore

d	l1	l2	l3	D	l	CrN	DLC	DC
						Order No.		
0.6	2.0	10	48	3	25.8	5321010	5381010	5391010
1.0	5.0	14	48	3	25.8	5321105	5381105	5391105
2.5	8.0	20	48	3	25.8	5321207	5381207	5391207

* compatible with "Imes-Icore 240/250"



d	l1	l2	l3	D	l	CrN	DLC	DC
						Order No.		
0.6	2.5	12	53	6	30	5324001	5384001	5394001
1.0	6.0	14	53	6	30	5324104	5384104	5394104
2.5	10.0	20	53	6	30	5324204	5384204	5394204
4.0	15.0	32	55	6		5324401		

* compatible with "Imes-Icore 350/550/750"



Roland

d	l1	l2	l3	D	l	CrN	DLC	DC
						Order No.		
0.6	1.5	6	50	4		5323001	5383001	5393001
1.0	3.5	16	50	4		5323103	5383103	5393103
2.0	3.5	16	50	4		5323201	5383201	5393201
1.0	3.5	20	50	4		5323104	5383104	5393104
2.0	5.0	25	52	4		5323202	5383202	5393202



Sirona

d	l1	l2	l3	D	l	DLC	DC
						Order No.	
0.5	1.0	5	42	3	23.5	5381012	5391012
1.0	3.5	16	43	3	24.5	5381103	5391103
2.5	5.0	25	43	3	25.5	5381222	5391222

立铣刀 - 氧化锆义齿专用
CAD/CAM End Mills - for Zirconia

VHF



d	l1	l2	l3	D	l	CrN	DLC	DC
						Order No.		
0.6	2.0	7	35	3	24	5321002	5381002	
1.0	3.5	16	35	3	24	5321101	5381101	5391101
2.0	3.5	16	35	3	24	5321201	5381201	5391201

* compatible with "VHF K1/K4"



d	l1	l2	l3	D	l	CrN	DLC	DC
						Order No.		
0.6	2.0	7	40	3	26.5	5321009	5381009	5391009
1.0	3.5	16	40	3	26.5	5321116	5381116	5391116
2.0	3.5	16	40	3	26.5	5321209	5381209	5391209

* compatible with "VHF K5"

Zirkon
Zahn



d	l1	l2	l3	D	l	CrN	DLC	DC
						Order No.		
0.5	3.0	6	57	3		5321005	5381005	5391005
1.0	6.0	12	57	3		5321110	5381110	5391110
2.0	10.0	18	57	3		5321215	5381215	5391215



d	l1	l2	l3	D	l	CrN	DLC	DC
						Order No.		
0.5	3.0	20	50	6			5384003	5394003
1.0	6.0	12	50	6			5384108	5394108
2.0	10.0	18	50	6			5384209	5394209
1.0	6.5	20	50	6		5324109		
2.0	8.0	17	50	6		5324210		

立铣刀 - 氧化锆义齿专用
CAD/CAM End Mills - for Zirconia



d	l1	l2	l3	D	l	CrN	DLC	DC
						Order No.		
0.7	2.0	7	35	3	24	5321001	5381001	
1.0	3.5	16	35	3	24	5321101	5381101	5391101
2.5	3.5	20	35	3	24	5321205	5381205	5391205

* compatible with "WIELAND MINI"



d	l1	l2	l3	D	l	CrN	DLC	DC
						Order No.		
0.7	2.0	7	40	3	26.5	5321007	5381007	5391007
1.0	3.5	16	40	3	26.5	5321116	5381116	5391116
2.5	5.0	20	40	3	26.5	5321212	5381212	5391212

* compatible with "WIELAND S1"



d	l1	l2	l3	D	l	CrN	DLC	DC
						Order No.		
0.6	4.5		50	3.4	30.8	5325001	5385001	5395001
1.0	4.0	14	50	3.4	30.8	5325101	5385101	5395101
2.4	5.0	25	50	3.4	30.8	5325201	5385201	5395201



d	l1	l2	l3	D	l	CrN	DLC	DC
						Order No.		
1.0	3.5	16	45	4	21.25	5323105	5383105	5393105
2.0	3.5	16	45	4	21.25	5323205	5383205	5393205

立铣刀 - 金属义齿专用
CAD/CAM End Mills - for Metal



Amann
Girrbach

d	l1	l2	l3	D	l	Order No.
1.0	5.0	7	43	3	16.3	5371121
2.0	5.0	7	43	3	16.3	5371232



Arum

d	l1	l2	l3	D	l	Order No.
1.0	2.0	10	50	6	/	5374114
1.5	3.0	10	50	6		5374115
2.0	4.0	12	50	6		5374214
3.0	6.0	12	50	6		5374302



Imes-Icore

d	l1	l2	l3	D	l	Order No.
1.0	3.0	8	45	6	21.5	5374117
1.5	3.0	8	45	6	21.5	5374118
2.0	3.0	12	45	6	21.5	5374216
3.0	3.0	15	45	6	21.5	5374304

Other



d	l1	l2	l3	D	Order No.
1.0	3.5	12	50	4	5373111
2.0	3.5	16	50	4	5373201
3.0	3.5	16	50	4	5373301
4.0	14.0	14	50	4	5373401



d	l1	l2	l3	D	Order No.
1.0	5.0	10	49	6	5374116
1.5	6.5	14	49	6	5374122
2.0	7.0	14	49	6	5374215
3.0	10.5	17	49	6	5374303

附录I - 推荐转速表

Index I - Speed Recommendation

Tungsten Carbide Dental Lab Burs			
Cut	Diameter (mm)	Application recommendation	Speed (rpm)
ISO 102 - Plain cut super fine	ø 2.3	Cut and polish precious alloy and non-precious alloy, leave a smoother surface.	30,000
	ø 2.5 - ø 4.5		20,000 - 35,000
ISO 110 - Cross cut super fine	ø 1.0 - ø 2.3	Cut and polish precious alloy and non-precious alloy.	30,000
	ø 2.5 - ø 4.5		20,000 - 35,000
ISO 133 - Plain cut fine	ø 0.9	Cut and pre-polish precious alloy and non-precious alloy, leave a smoother surface.	40,000
	ø 2.3		30,000
	ø 2.5 - ø 4.5		20,000 - 35,000
ISO 134 - Spiral cut fine	ø 2.3	For all alloys.	30,000
	ø 4.0		25,000
	ø 6.0		20,000
ISO 137 - Spiral cut super fine	ø 1.0 - ø 2.3	For all alloys.	25,000 - 40,000
	ø 4.0		25,000
	ø 6.0		20,000
ISO 140 - Cross cut fine	ø 1.0 - ø 2.3	Cut and pre-polish precious alloy and non-precious alloy.	25,000 - 40,000
	ø 2.5 - ø 4.5		20,000 - 35,000
	ø 5.0 - ø 7.0		15,000 - 30,000
ISO 141 - Diamond cut for slightly rough surface	ø 2.3	For crown veneer.	30,000
	ø 4.5		15,000
ISO 175 - Plain cut standard	ø 2.5 - ø 4.5	Cut precious alloy, leave a smoother surface.	20,000 - 35,000
	ø 5.0 - ø 7.0		15,000 - 30,000
	ø 2.5 - ø 4.5	Cut acrylics and plasters, leave a smoother surface.	20,000 - 30,000
	ø 5.0 - ø 7.0		15,000 - 25,000
ISO 176 - Straight edge with spiral cut	ø 2.3	Cut acrylics, sharper and better chips removal.	30,000
	ø 2.5 - ø 4.5		15,000 - 25,000
	ø 5.0 - ø 7.0		10,000 - 20,000
	ø 1.0 - ø 2.3		25,000 - 40,000
ISO 190 - Cross cut standard	ø 2.5 - ø 4.5	Cut precious alloy.	20,000 - 35,000
	ø 5.0 - ø 7.0		15,000 - 30,000
	ø 1.0 - ø 2.3		20,000 - 30,000
	ø 2.5 - ø 4.5	Cut acrylics and plasters.	15,000 - 25,000
	ø 5.0 - ø 7.0		10,000 - 20,000
	ø 2.3		30,000
ISO 191 - Diamond cut for prism surface	ø 2.3	For ceramic or resin veneer.	30,000
	ø 4.5		15,000
ISO 194 - Straight edge with cross cut	ø 1.0 - ø 2.3	For titanium alloy.	25,000 - 40,000
	ø 2.5 - ø 4.5		20,000 - 35,000
ISO 215 - Plain cut coarse	ø 2.5 - ø 4.5	Grind acrylics and plasters, leave a smoother surface.	15,000 - 25,000
	ø 5.0 - ø 7.0		10,000 - 20,000
ISO 220 - Cross cut coarse	ø 2.5 - ø 4.5	Grind acrylics and plasters.	15,000 - 25,000
	ø 5.0 - ø 7.0		10,000 - 20,000
ISO 222 - Plain cut super coarse	ø 5.0 - ø 7.0	Grind acrylics and plasters, leave a smoother surface.	10,000 - 20,000
ISO 223 - Cross cut super coarse	ø 5.0 - ø 7.0	Grind acrylics and plasters.	10,000 - 20,000

Zirconia Ceramic Dental Lab Burs			
Shape	Diameter (mm)	Application recommendation	Speed (rpm)
ISO 001 - Ball shape	ø 2.3	Suitable for trimming acrylic resin, plaster, etc.	50,000
	ø 2.5 - ø 4.5		40,000 - 50,000
	ø 5.0 - ø 7.0		45,000
ISO 113 - End cut shape	ø 6.0		25,000
ISO 141 - Cylindrical shape	ø 1.0 - ø 2.3		50,000
	ø 1.0 - ø 4.0		50,000
ISO 201 - Conical shape	ø 4.5		30,000
	ø 6.0	25,000	
ISO 272 - Bullet shape	ø 6.0	25,000 - 45,000	

附录II - 产品索引

Index II - Reference Form

Order No.	Description	Page	Order No.	Description	Page	Order No.	Description	Page	Order No.	Description	Page
Tungsten Carbide Dental Lab Burs			5000343	257 190 060	08	5001409	239 134 023	12	5403105	4° 200 135 031	14
5000101	141 110 023	07	5000344	213 190 060	08	5001410	237 134 023	12	5403106	6° 200 135 040	14
5000102	145 110 023	07	5000345	263 190 040	08	5001411	274 134 040	12	5404101	0° 137 366 010	14
5000103	180 110 023	07	5000346	263 190 060	08	5001412	275 134 060	12	5404102	0° 137 366 015	14
5000104	198 110 016	07	5000348	274 190 040	08	5001413	290 134 023	12	5404103	0° 137 366 023	14
5000105	198 110 023	07	5000349	272 190 060	08	5001501	141 194 023	11	5404104	2° 200 217 023	14
5000106	200 110 045	07	5000350	275 190 060	08	5001502	198 194 023	11	5404105	4° 200 217 031	14
5000107	201 110 023	07	5000352	277 190 023	08	5001503	198 194 016	11	5404106	6° 220 217 040	14
5000108	201 110 040	07	5000353	277 190 060	08	5001504	200 194 040	11	Tungsten Carbide Pindes Drills		
5000109	201 110 045	07	5000354	289 190 023	08	5001505	289 194 023	11	5600008	1.95mm	12
5000110	227 110 023	07	5000355	292 190 023	08	5001601	141 141 023	11	5600009	2.00mm	12
5000112	239 110 023	07	5000401	143 220 060	09	5001602	145 141 023	11	5600012	1.85mm	12
5000113	237 110 023	07	5000402	200 220 045	09	5001603	201 141 045	11	5600013	1.75mm	12
5000114	237 110 029	07	5000403	201 220 060	09	5001604	289 141 023	11	5600014	1.60mm	12
5000115	257 110 023	07	5000404	237 220 060	09	5001605	292 141 023	11	5600015	1.55mm	12
5000117	274 110 040	07	5000405	239 220 060	09	5001701	145 191 023	11	5600020	2.22mm	12
5000118	277 110 023	07	5000406	257 220 060	09	5001704	201 191 023	11	Zirconia Ceramic Dental Lab Burs		
5000119	289 110 023	07	5000407	263 220 060	09	5001705	201 191 045	11	6300205	4.0conical	17
5000120	292 110 023	07	5000408	263 220 070	09	5001706	289 191 023	11	6300206	2.3cylindrical	18
5000201	001 140 023	07	5000409	272 220 060	09	5001707	292 191 023	11	6300207	2.3conical	17
5000202	116 140 023	07	5000601	143 223 060	09	CAD/CAM End Mills			6300211	1.2cylindrical	18
5000203	141 140 023	07	5000602	263 223 070	09	5301001	Wieland mini	23	6300301	6.0bullet	16
5000204	143 140 060	07	5000603	275 223 060	09	5301002	VHFK1/ K4	22	6300304	3.0ball	18
5000205	145 140 023	07	5000701	145 102 023	09	5301005	ZirkonZahn	22	6300305	4.0conical	17
5000206	180 140 023	07	5000705	201 102 023	09	5301006	Amann Girrbach	20	6300312	1.6conical	17
5000207	198 140 016	07	5000706	201 102 045	09	5301007	Wieland S1	23	6300315	2.3ball	18
5000208	198 140 023	07	5000708	292 102 023	09	5301009	VHF K5	22	6300401	6.0bullet	16
5000209	199 140 031	07	5000801	116 133 023	09	5301010	Imes-Icore 240/250	21	6300405	4.0conical	17
5000210	200 140 045	07	5000802	145 133 023	09	5301012	Sirona	21	6300501	6.0bullet	16
5000211	201 140 023	07	5000803	196 133 009	09	5301011	VHF K1/K4 Wieland mini	22/23	6300504	3.0ball	18
5000212	201 140 040	07	5000804	201 133 023	09	5301102	3M ESPE Lava	20	6300505	4.0conical	17
5000213	201 140 060	07	5000805	201 133 040	09	5301103	Sirona	21	6300517	4.0ball	18
5000214	227 140 023	07	5000806	237 133 023	09	5301104	Amann Girrbach	20	6300518	5.0ball	18
5000216	237 140 023	07	5000807	289 133 012	09	5301105	Imes-Icore 240/250	21	6300519	6.0ball	18
5000217	237 140 029	07	5000808	292 133 023	09	5301109	3M ESPE Lava	20	6300601	6.0bullet	16
5000218	237 140 060	07	5000901	001 175 027	10	5301110	ZirkonZahn	22	6300605	4.0conical	17
5000219	239 140 060	07	5000902	001 175 031	10	5301116	VHF K5 Wieland S1	22/23	6300701	6.0bullet	16
5000221	257 140 040	07	5000903	001 175 040	10	5301201	VHFK1/ K4	22	6300705	4.0conical	17
5000222	257 140 060	07	5000904	001 175 050	10	5301202	3M ESPE Lava	20	6300801	6.0bullet	16
5000223	263 140 040	07	5000905	001 175 060	10	5301205	Wieland mini	23	6300805	4.0conical	17
5000224	263 140 060	07	5000906	113 175 060	10	5301206	Amann Girrbach	20	6310518	5.0ball	18
5000226	272 140 060	07	5000907	143 175 060	10	5301207	Imes-Icore 240/250	21	6400201	6.0bullet	16
5000227	275 140 060	07	5000911	199 175 031	10	5301209	VHF K5	22	6400202	6.0conical	17
5000229	277 140 023	07	5000912	200 175 045	10	5301212	Wieland S1	23	6400301	6.0bullet	16
5000230	277 140 060	07	5000913	201 175 040	10	5301213	3M ESPE Lava	20	6400302	6.0conical	17
5000233	289 140 023	07	5000914	201 175 060	10	5301215	ZirkonZahn	22	6400305	4.0conical	17
5000234	292 140 023	07	5000915	213 175 060	10	5301222	Sirona	21	6400401	6.0bullet	16
5000301	001 190 010	08	5000916	237 175 060	10	5303001	Roland	21	6400402	6.0conical	17
5000302	001 190 012	08	5000917	239 175 060	10	5303103	Roland	21	6400405	4.0conical	17
5000303	001 190 014	08	5000918	257 175 060	10	5303104	Roland	21	6400501	6.0bullet	16
5000304	001 190 016	08	5000919	263 175 060	10	5303201	Roland	21	6400502	6.0conical	17
5000305	001 190 018	08	5000920	274 175 040	10	5303202	Roland	21	6400503	6.0end cut	18
5000306	001 190 023	08	5000921	272 175 060	10	5304003	ZirkonZahn	22	6400505	4.0conical	17
5000307	001 190 025	08	5000922	275 175 060	10	5304101	Imes-Icore 350/550/750	21	6400517	4.0ball	18
5000308	001 190 027	08	5000923	277 175 060	10	5304102	Dentium	20	6400518	5.0ball	18
5000310	001 190 030	08	5001001	143 215 060	10	5304104	Imes-Icore 350/550/750	21	6400519	6.0ball	18
5000312	001 190 035	08	5001002	200 215 045	10	5304107	ARUM	20	6400601	6.0bullet	16
5000313	001 190 040	08	5001003	201 215 060	10	5304108	ZirkonZahn	22	6400602	6.0conical	17
5000314	001 190 050	08	5001004	237 215 060	10	5304109	ZirkonZahn	22	6400603	6.0end cut	18
5000315	001 190 060	08	5001005	257 215 060	10	5304202	Dentium	20	6400605	4.0conical	17
5000316	001 190 080	08	5001006	263 215 060	10	5304204	Imes-Icore 350/550/750	21	6400619	6.0ball	18
5000317	113 190 060	08	5001007	275 215 060	10	5304208	ARUM	20	6400701	6.0bullet	16
5000318	116 190 023	08	5001101	143 222 060	10	5304209	ZirkonZahn	22	6400702	6.0conical	17
5000319	141 190 023	08	5001102	263 222 070	10	5304210	ZirkonZahn	22	6400719	6.0ball	18
5000320	143 190 060	08	5001103	275 222 060	10	5304401	Imes-Icore 350/550/750	21	6400801	6.0bullet	16
5000321	145 190 023	08	5001201	201 176 023	11	Tungsten Carbide Milling Instrument			6400802	6.0conical	17
5000322	180 190 023	08	5001202	201 176 045	11	5401101	0° 137 190 010	14	6402305	4.0conical	17
5000326	198 190 016	08	5001203	237 176 040	11	5401102	0° 137 190 015	14	6402401	6.0bullet	16
5000327	198 190 023	08	5001204	263 176 060	11	5401103	0° 137 190 023	14	6402501	6.0bullet	16
5000328	199 190 031	08	5001205	263 176 070	11	5401104	2° 200 190 023	14	6402505	4.0conical	17
5000329	200 190 045	08	5001206	275 176 060	11	5401105	4° 200 190 031	14	6402601	6.0bullet	16
5000330	201 190 023	08	5001301	141 137 023	12	5401106	6° 200 190 040	14	6405401	6.0bullet	16
5000331	201 190 040	08	5001303	198 137 016	12	5402102	0° 137 220 010	14	6405501	6.0bullet	16
5000332	201 190 060	08	5001304	198 137 023	12	5402102	0° 137 220 015	14	6405601	6.0bullet	16
5000333	225 190 016	08	5001305	200 137 040	12	5402103	0° 137 220 023	14	6410201	6.0bullet	16
5000334	227 190 023	08	5001307	200 137 060	12	5402104	2° 200 220 023	14	6410301	6.0bullet	16
5000335	239 190 023	08	5001308	289 137 023	12	5402105	4° 200 220 031	14	6410401	6.0bullet	16
5000336	237 190 023	08	5001401	142 134 023	12	5402106	6° 200 220 040	14	6410501	6.0bullet	16
5000337	237 190 029	08	5001402	185 134 023	12	5403101	0° 137 135 010	14	6410601	6.0bullet	16
5000338	237 190 060	08	5001406	196 134 040	12	5403102	0° 137 135 015	14			
5000339	239 190 060	08	5001407	201 134 023	12	5403103	0° 137 135 023	14			
5000341	257 190 023	08	5001408	199 134 023	12	5					

WILSON Precision Tool U.S.A Inc.

329W. 18th Street, Suite 309

Chicago, IL 60616, USA

Tel: + 1 (312) 243-6680

Fax: + 1 (312) 243-7366

Email: vincent.zhang@wilsonprecisiontool.com



Cooperate with:



#703 7th Floor, Posco thesharp Building

27, Chilpae-ro, Jung-gu, Seoul, KOREA

Tel: + 82 2 312-2878

Fax: + 82 2 312-2871

Email: dmaxdental@naver.com

Internet: www.dmaxdental.co.kr



Shojaee Dental Supply Co.

Unit 25, Kaveh Building

Azadi ave, Tehran, IRAN

Tel: + 98 21 66914070

Fax: + 98 21 66433193

Email: info@masoushojaei.com

Internet: www.shojaeedental.com



WELL-SUN

上海惠而顺精密工具股份有限公司 (总公司)
Shanghai WELL-SUN Precision Tool Co., Ltd.

地址 Add : 上海市宝山区真陈路868号3幢厂房
#3 Workshop, No. 868 Zhenchen Rd.
Baoshan Urban Industry Park
Shanghai, CHINA

电话 Tel : 86-21-36162006

传真 Fax : 86-21-36162016

网址 Web : www.wilsonprecisiontool.com
www.wilsonshopping.com